



Supervisor Tony Buffington

## Blue Ridge District

NewsFlash

### **Belmont Ridge Road (Truro Parish - Croson Lane) Widening Project Update**

**Waxpool Road Temporary Closure - THIS WEEKEND!**

**Lane Shifts on Belmont Ridge Road (Beginning May 19)**

Sent: May 18, 2023

#### **Belmont Ridge Road and Waxpool Road Temporary Detour (May 19 - 22, 2023)**

Access to and from Waxpool Road at Belmont Ridge Road will be closed **from Friday, May 19 beginning at 8:00 pm to Monday, May 22 at 5:00 am.**

Drivers should follow the detour to enter and exit from Waxpool Road to Belmont Ridge Road. [See detour diagram below.](#)

This work is weather dependent and is subject to rescheduling to a future weekend.

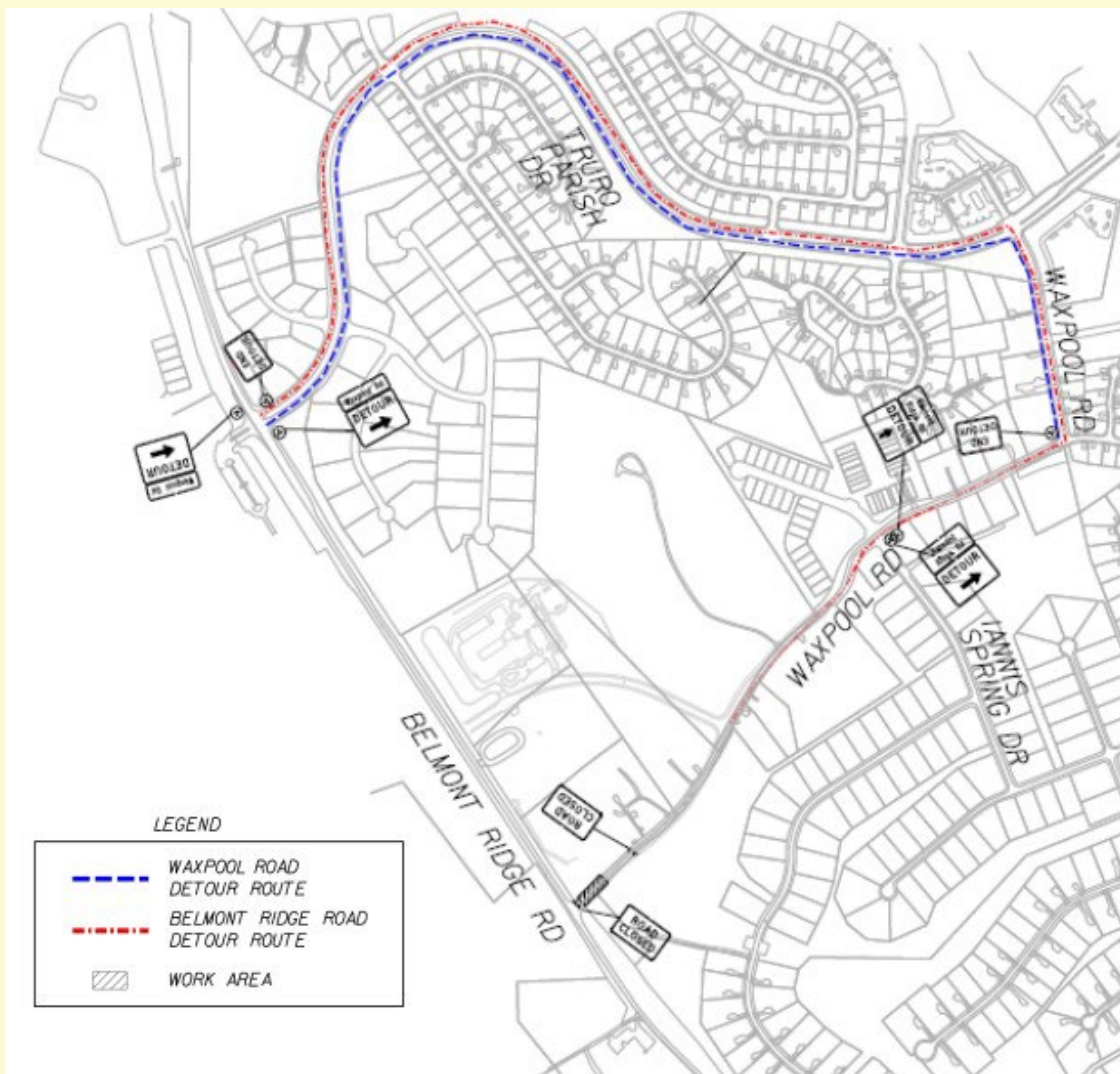

### **Traffic Shifts on Belmont Ridge Road (On or About May 19)**

On or about May 19, 2023, weather permitting, Belmont Ridge Road northbound and southbound traffic will be switched on to new roadway alignments between Reservoir Ridge Place and Truro Parish Drive.

Lanes will continue to be a single lane in each direction using both new temporary crossover lanes and newly paved travel lanes.

Drivers should use extra caution and slow down when traveling through these areas. Please follow all directions from the posted detour signs and road crews as heavy construction is underway and residents are entering and exiting their neighborhoods off Belmont Ridge Road between Croson Lane and Truro Parish Drive.

For more information, visit the [project page](#) and [sign up](#) to receive project updates.

### **About the Project:**

This project designs and constructs two additional lanes of Belmont Ridge Road from Truro Parish Drive to Croson Lane. The improvements will consist of reconstructing and widening the existing two-lane roadway to a four-lane divided roadway with a ten foot shared use path on both sides.

The Project includes two northbound and two southbound lanes, associated turn lanes at the intersections of Croson Lane, Cochrans Lock Drive, Reservoir Ridge Place, Mount Hope Road, Waxpool Road, Black Angus Drive, Truro Parish Drive, a grass median, stormwater management facilities, landscaping, and modifications to the existing traffic signals at Croson Lane and Truro Parish Drive.

Construction is currently estimated to be completed in Summer 2024, weather permitting.

### **Project Significance:**

- The corridor is one of four major north/south roadways in Loudoun County (along with Route 15, Loudoun County Parkway and Route 28) and has been designated by the

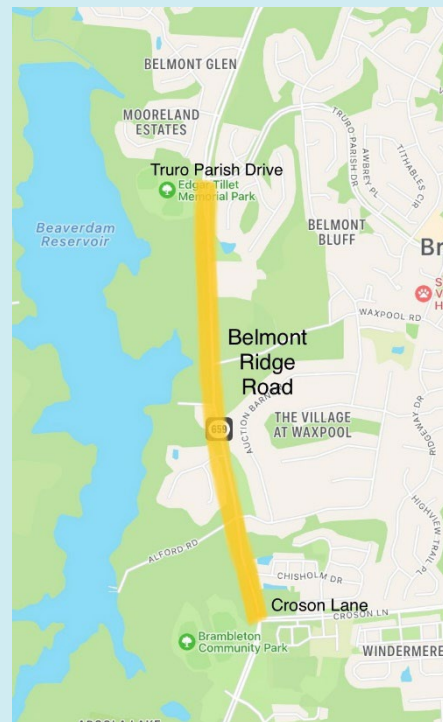

Commonwealth of Virginia as a "Corridor of Statewide Significance."

- The project provides shared use paths alongside Belmont Ridge in accordance with the Countywide Transportation Plan (CTP). The shared use paths will ultimately provide continuous access to/from the W&OD Regional Trail.
- The widening from two to four lanes will increase safety and reduce traffic congestion.
- The project upgrades a rural sub-standard two lane roadway to modern safety and level of service standards.
- The 1.5 mile segment of widening represents the last section of two lane Belmont Ridge Roadway between Route 7 and Evergreen Mills Road.
- Combined with the future completion of Northstar Boulevard, this will provide a continuous four lane divided roadway between Route 7 and Route 50.



**Loudoun County**

**VIRGINIA**

WHERE TRADITION MEETS INNOVATION

---

All our best!

Tony Buffington  
Blue Ridge District Supervisor

[tony.buffington@loudoun.gov](mailto:tony.buffington@loudoun.gov)

Christi Maple

Chief of Staff

[christi.maple@loudoun.gov](mailto:christi.maple@loudoun.gov)

Robin Bartok

Senior Legislative Aide

[robin.w.bartok@loudoun.gov](mailto:robin.w.bartok@loudoun.gov)

Click [here](#) to Like us on Facebook!



Blue Ridge District | 1 Harrison Street, S.E. 5th Floor, PO Box 70000, Leesburg, VA 20177-7000

Sent by [tony.buffington@loudoun.gov](mailto:tony.buffington@loudoun.gov) powered by

